

Specifications on this page are subject to change without notice. Every attempt has been made to ensure the accuracy of this drawing, however Traxxas cannot be held responsible for typographical or other errors.

NTRO4TEC ALL-WHEEL-DRIVE SUPERCAR 3.3 **Front Assembly**

NITRO4TEC 3.3

ALL-WHEEL-DRIVE SUPERCAR

Rear Assembly

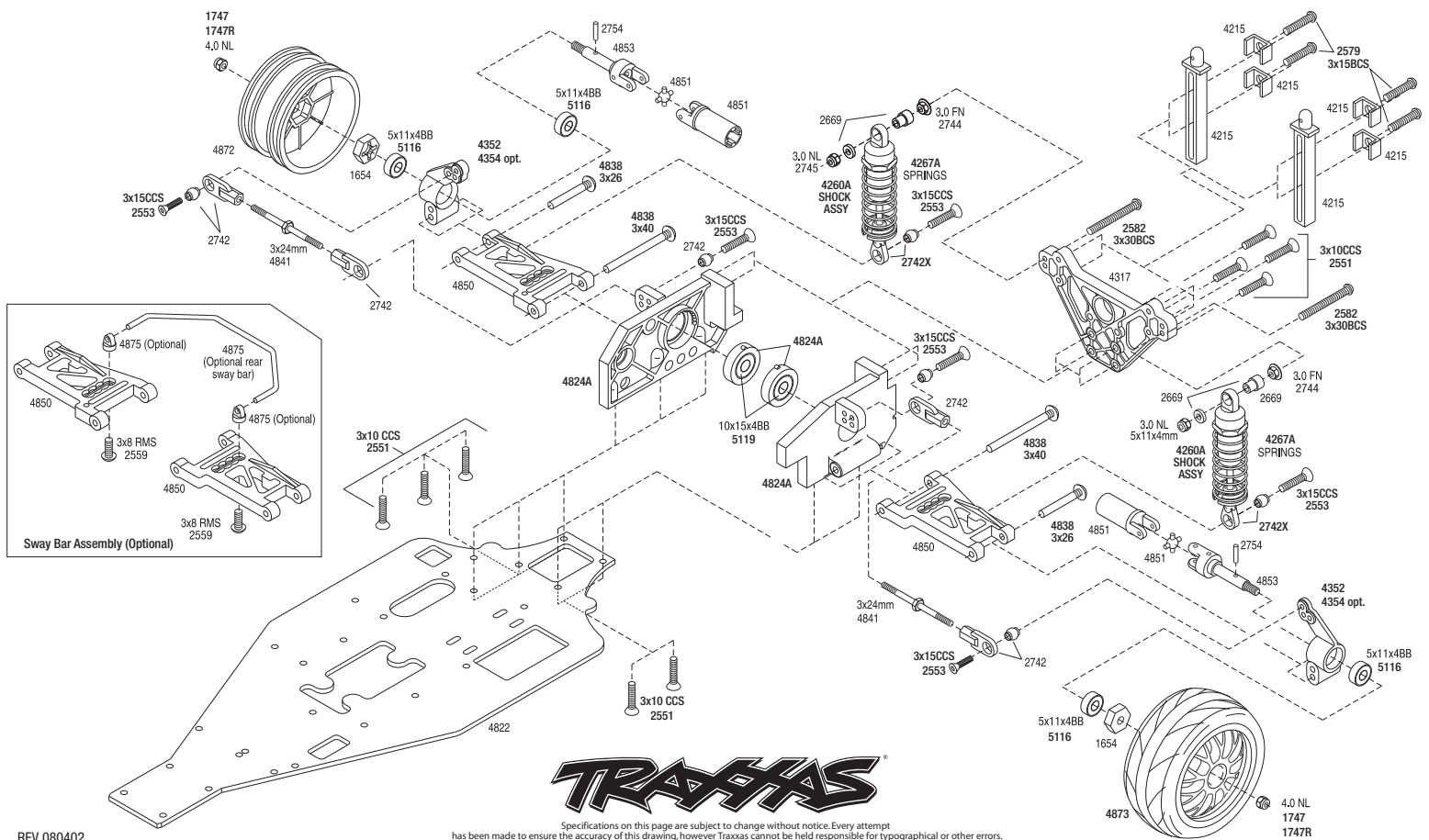

REV 080402

Specifications on this page are subject to change without notice. Every attempt has been made to ensure the accuracy of this drawing, however Traxxas cannot be held responsible for typographical or other errors.

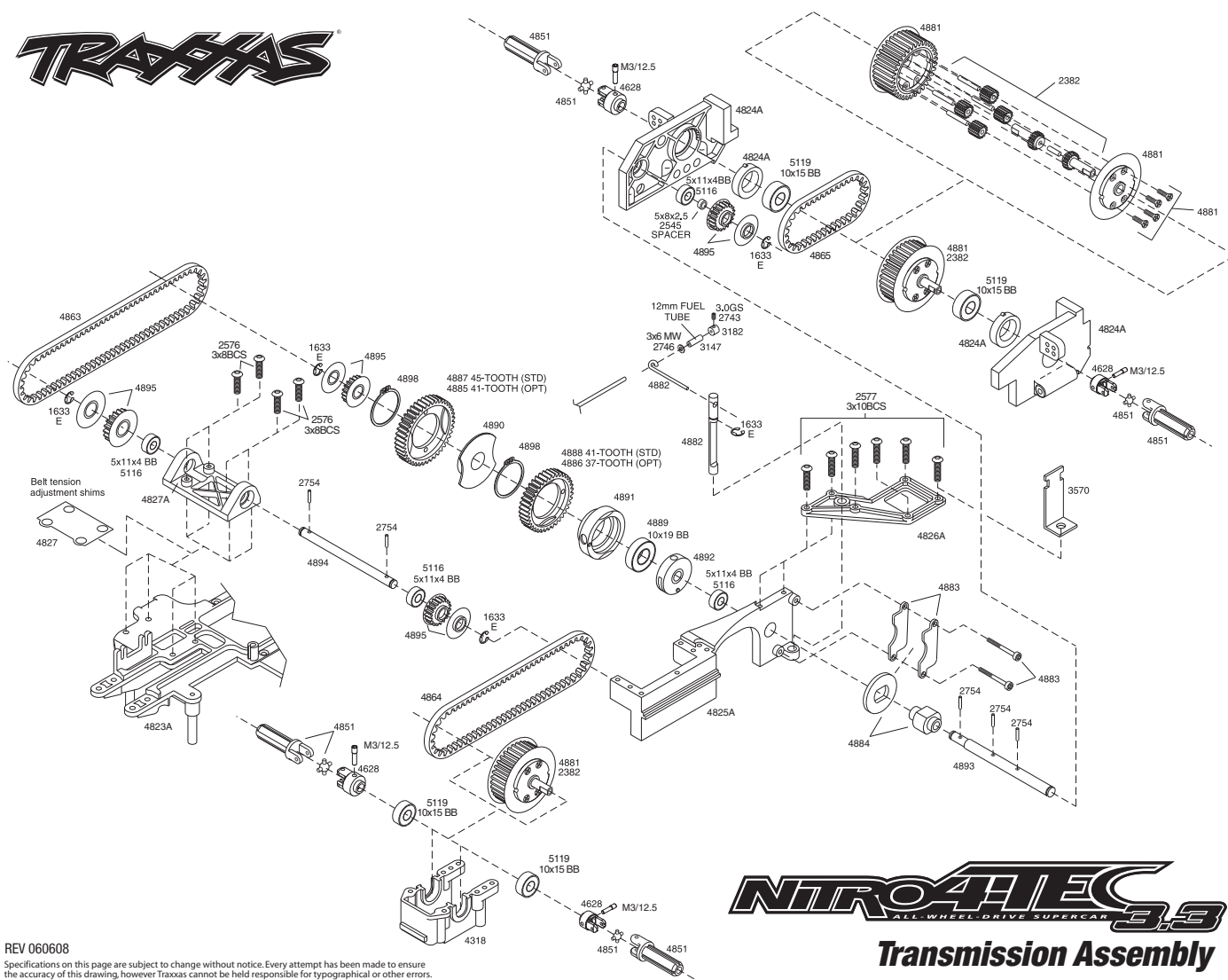

REV 060608

Specifications on this page are subject to change without notice. Every attempt has been made to ensure the accuracy of this drawing, however Traxxas cannot be held responsible for typographical or other errors.

NTRO4IEC ALL-WHEEL-DRIVE SUPERCAR 3.3 **Transmission Assembly**